



Microsoft ARC TOUCH Quick Start Guide

[Manuals](#) / [Brands](#) / [Microsoft Manuals](#) / [Mouse](#) / [ARC TOUCH](#) / [Quick start manual](#) / PDF

Contents

- 1 Power on
- 2 Pair your mouse with your Device
- 3 Controls
- 4 Documents / Resources
 - 4.1 References



Power on

1

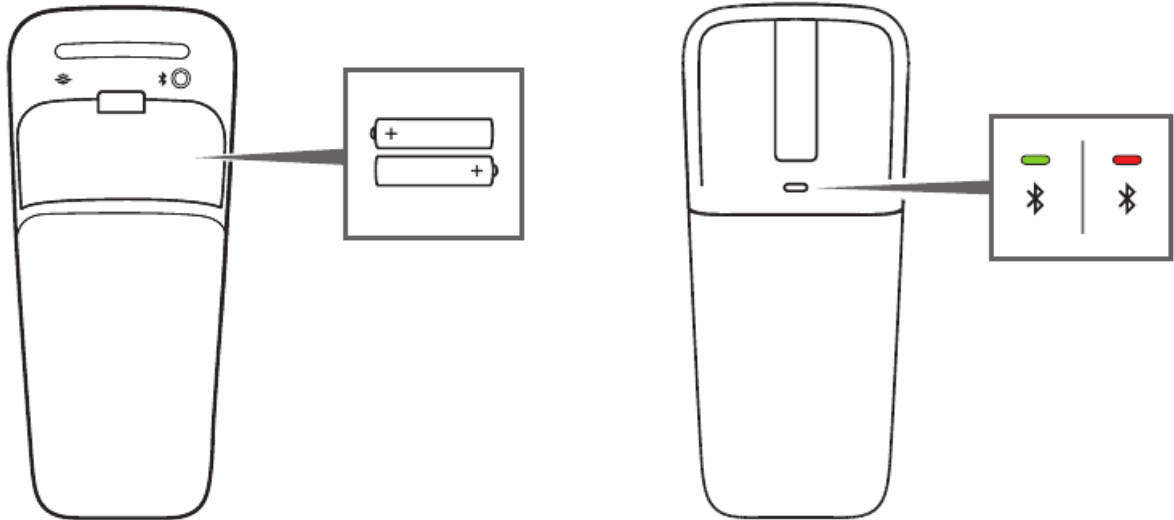

2

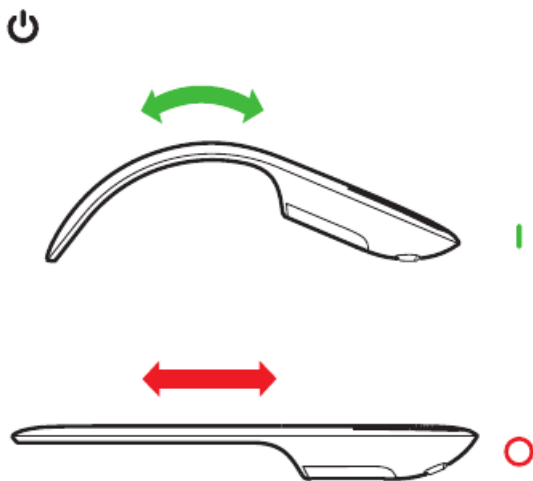

3

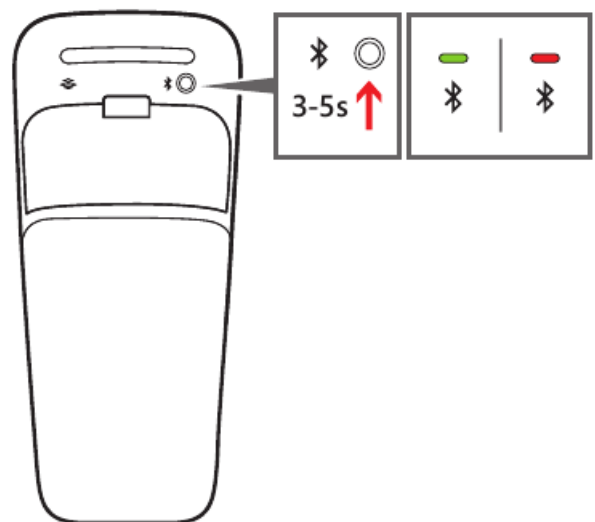

www.microsoft.com/hardware/downloads

www.microsoft.com/hardware/support

Pair your mouse with your Device

Step 1: On the bottom of the mouse, press and hold the **Power/Connect** button for 3 to 5 seconds. The light on the bottom of the mouse blinks slowly on and off until your Device successfully discovers your mouse.

Step 2: From the Start screen type **PC Settings**.

Step 3: Click **PC and devices**.

Step 4: Click **Bluetooth**.

Step 5: Click **Mouse**, and then click **Pair**.

Controls

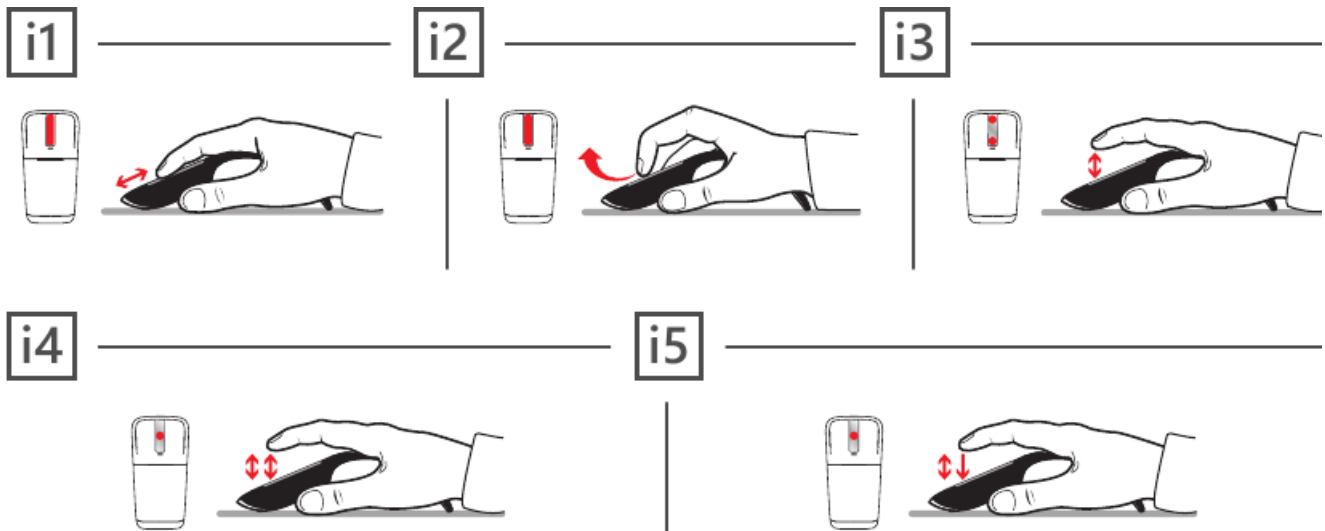

i1 Slide your finger up or down the touch strip to scroll.

i2 Flick your finger up or down to scroll quickly.

i3 Tap at the top or bottom to page up or page down.

i4 Double-tap in the middle to middle click. (In Windows Internet Explorer, middle-click a link to open the link in a new tab.)

i5 Double-tap and hold equals middle drag. (In Microsoft Word and Excel, middle drag to AutoScroll.)

www.microsoft.com/hardware/support



Documents / Resources

References

[PC accessories help & learning](#)

[PC accessories help & learning](#)

