

Menu

- Preparation
- Legion Glasses
 - Customize your prescription lens
 - Select and adjust nose pads
 - Adjustable temple and anti-slip adapter
 - Speakers
 - Buttons and functions
- Connect Legion Glasses to Legion Go

Preparation

- Legion Go device
 - Already installed games on Legion Go
- Legion Glasses device and accessories
 - Prescription lens
 - Nose pads
 - Anti-slip adapters

Legion Glasses offers a novel, smarter big screen solution for any consumer who seeks a portable, immersive, and private display for on-the-go gaming.

Legion Glasses - Customize your prescription lens

Both prescription lens frame template and this guide are in box.

Please take the prescription lens template and the guide to the local optical shops to customize your prescription lens (additional fees needed).

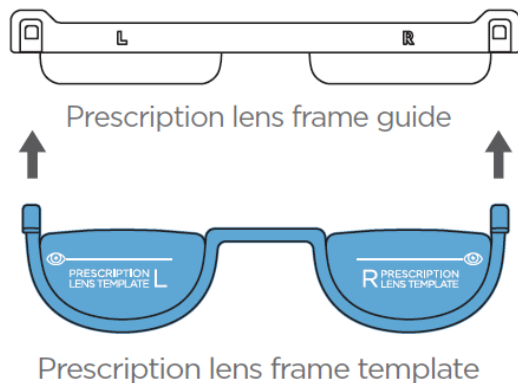

How to assemble the prescription lens?

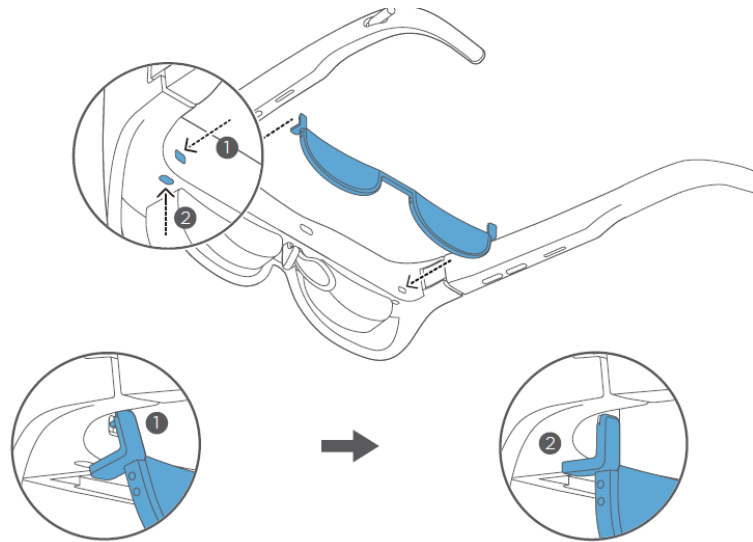

Fasten the snap at ① to the top slot

Gently tap the frame towards ② until it snaps tightly

Legion Glasses - Select and adjust the nose pad

Select a nose pad and adjust its shape to get you the best view of virtual image in the glasses and keep the image in the center of your vision.

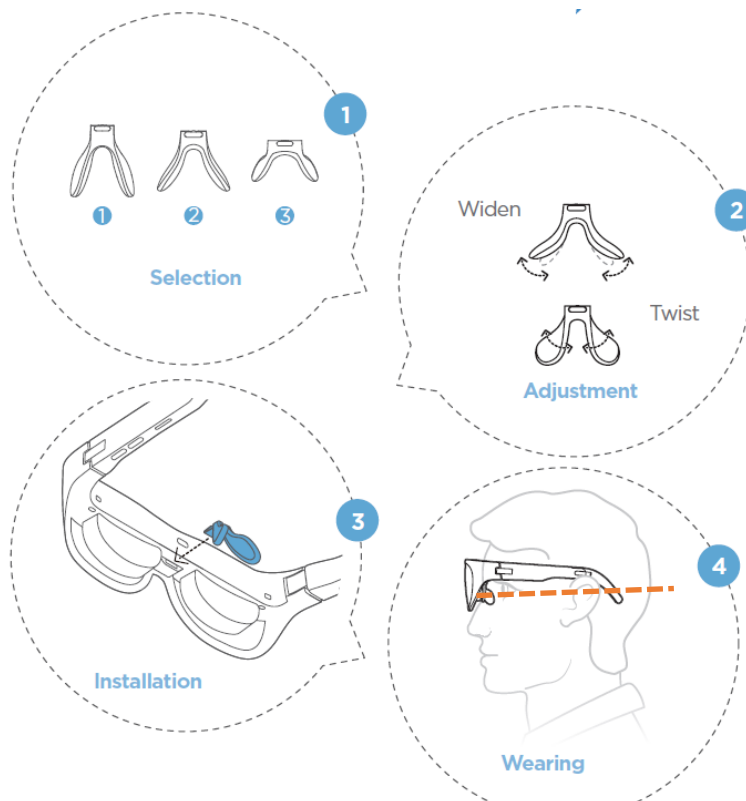

Legion Glasses - Adjustable temple and anti-slip adapter

Bend the ends of the temples inward to improve wearing stability.

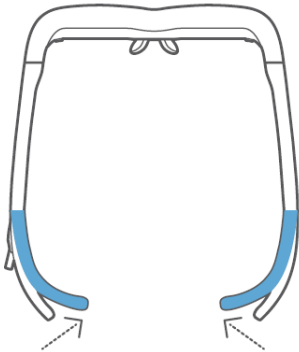

It is recommended to slide on the glasses from top to bottom.

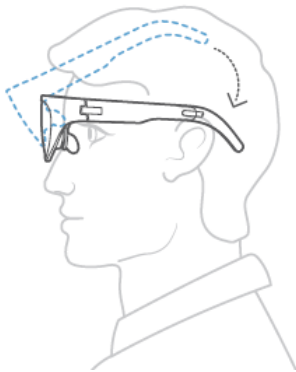

The anti-slip adapters, in the accessories box, are designed for small or narrow head. The letters "L" and "R" marked on the anti-slip adapter represent left and right to make them easy to distinguish. Install the anti-slip adapters on the temples tightly with the "IN" sides facing the temples.

(Mention the cable hook)

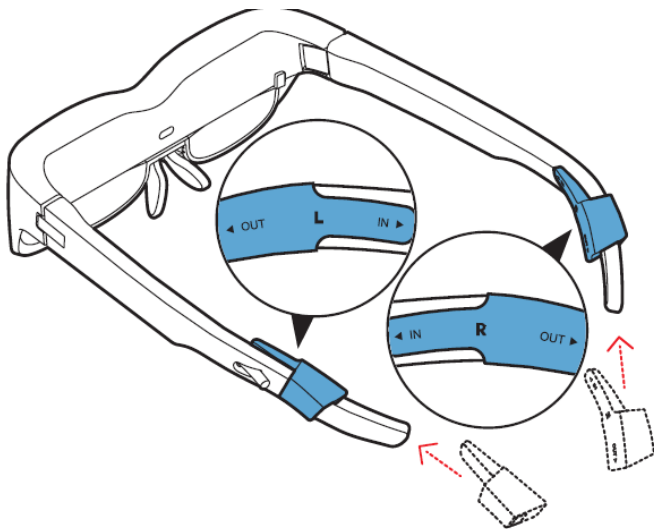

Legion Glasses - Speakers

- Audio speakers are built into each temple arm for a high-fidelity, open-ear experience.



Legion Glasses - Buttons and functions

- Short press:
 - Left temple arm: Screen brightness
 - Right temple arm: Volume level
- Long press:
 - Left front: Enable/Disable Anti-blue-light mode
 - Left rear: Screen blank

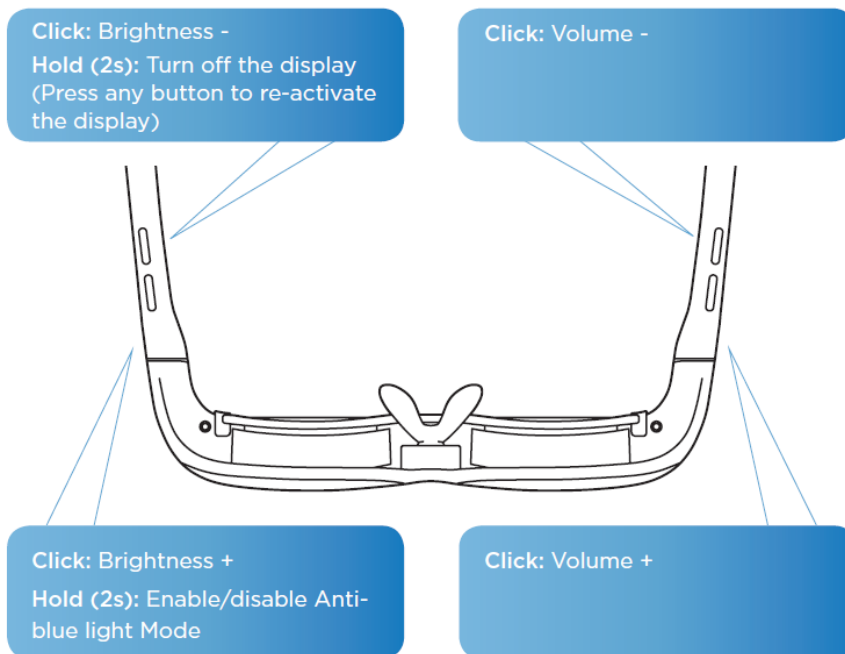

Connect Legion Glasses to Legion Go

Legion Go has two full functional USB-C connectors with DP out. Both connectors could be able to support Legion Glasses.

While we connect Legion Glasses to one of the USB-C ports, we can use the other USB-C port for charging.



Launcher for Legion Glasses

- Icons center aligned
- Release in September

